

FI Asennusohje
 S Installation instruktioner
 N Installationsinstruktioner
 DK Installasjonsinstruktus
 NL Installatievoorschrift
 D Montageanweisung
 F Instructions d'installation
 ES Instrucciones de montaje
 I Istruzioni di montaggio

ML6435B/ML7435E

Electric Linear Actuators for Floating/Modulating Control

INSTALLATION INSTRUCTIONS

		<p>A1-A9: Installation</p>
<p>A1</p>	<p>A2</p>	<p>A3</p>
<p>A4</p>	<p>A5</p> <p>A6</p>	<p>A7</p>

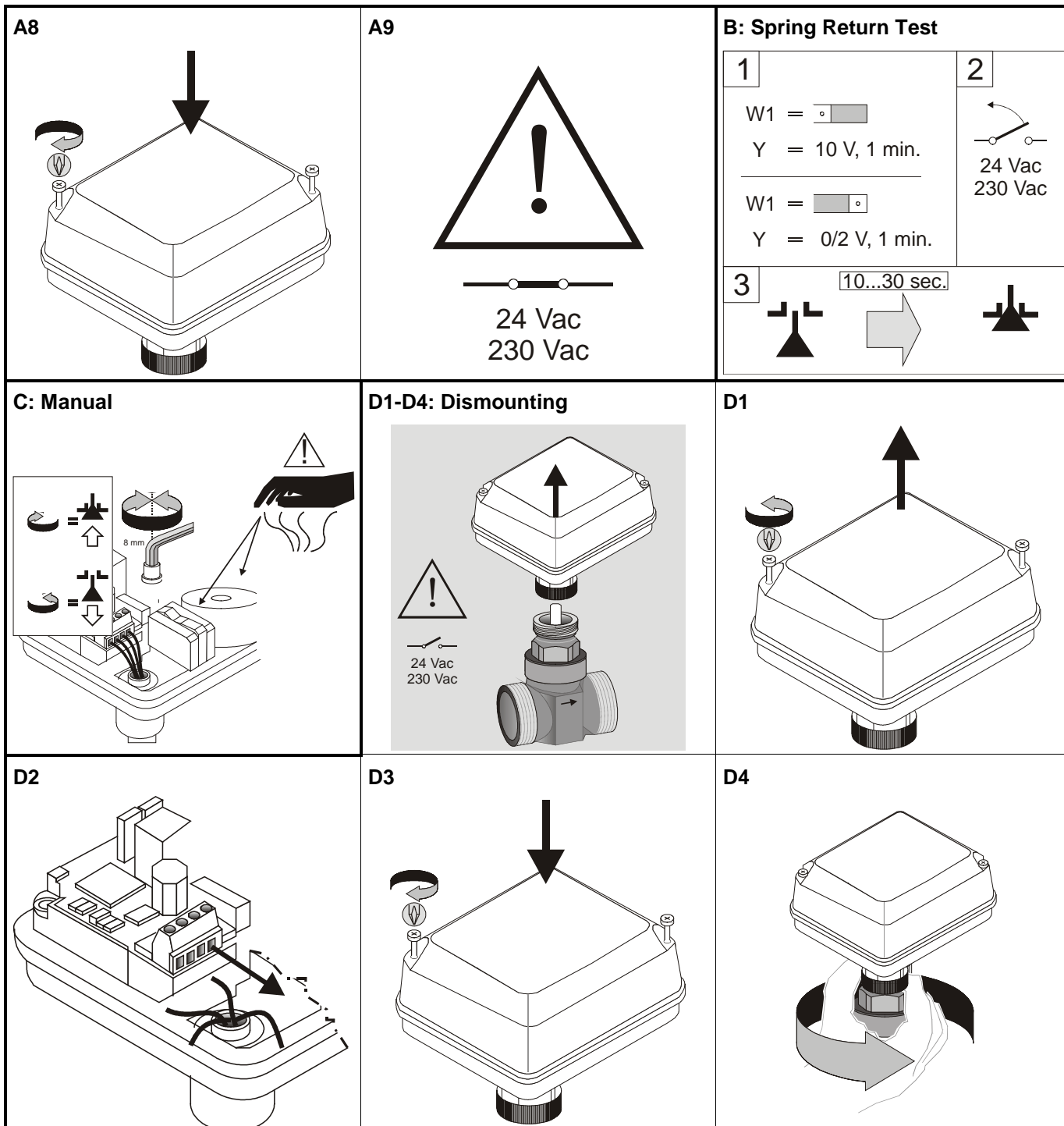

ROBINEX AG SA

Armaturen Robinetterie Rubinetterie

Bernstrasse 36, CH-4663 Aarburg/Oftringen

Telefon 062 787 70 00, Fax 062 787 70 01

info@robinex.ch, www.robinex.ch